



Cartridge Changeout Instructions

Step 1 - Cartridge Removal

- Shut off inlet valve on manifold.
- Open the flush valve located on outlet side of manifold to release pressure. Close the flush valve.
- Turn filter counterclockwise (as viewed from bottom). Pull down to remove.

CAUTION: filter contains water and may be heavy

Step 2 - Lubrication

- Remove and discard blue sanitary cap from the top of new filter. Open up lubrication packet (included) and apply to fingertip. Apply lubrication to large black O-ring located on the outside of the open cartridge top cap (see Page 2 for detailed instructions).
- Apply lubrication to the TWO small black O-rings located on the outside of the black center tube (see Page 2 for detailed instructions)

Step 3 - Cartridge Replacement

- Align tabs on filter with notches in manifold.
- Push firmly upward to insert filter. Ensure filter is fully inserted
- Firmly turn filter clockwise (as viewed from bottom), until a definite stop is felt, and filter is seated (Increased torque may be required).
- Slowly open inlet valve on manifold.
- Open the flush valve on the outlet side of manifold.
- Flush system for 5 minutes.
- Close the flush valve.
- Change out filter annually or when capacity has been reached.



Step 1



Step 2
Lubricate
O-rings

Step 3

NOTE: Increased torque may be required when turning cartridge to ensure cartridge is properly seated into manifold.



Cartridge Lubrication Process

FILTER CARTRIDGE LUBRICATION

Step #1

Generously apply lubricant to fingertip. Run finger around the entire circumference of the large black O-ring, located on the outside of open cartridge top cap (lubricant is applied where the red arrow points).

Step #2

Generously apply lubricant to fingertip. Run finger around the circumference of the TWO small black O-rings, located on the outside of the black center tube (lubricant is applied where the red arrow points).

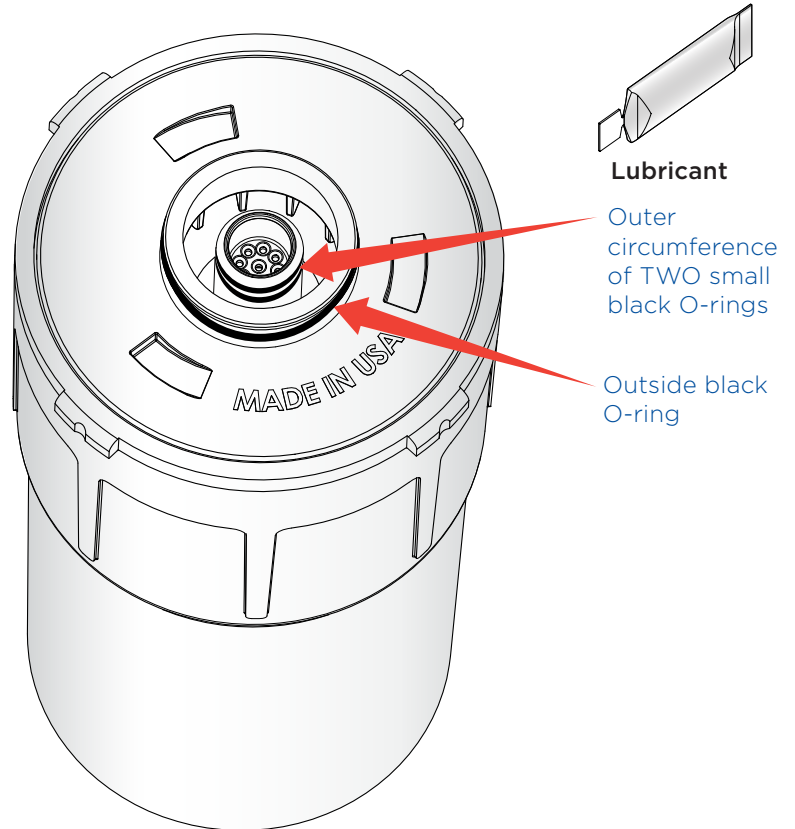

Or Alternative Method

FILTER MANIFOLD LUBRICATION

Generously apply lubricant to fingertip. Run finger around the circumference of BOTH black center tube and center core receptacles for cartridge (lubricant is applied where BOTH red areas are shown).

